

SUZUKI DL650 V-Strom

Parts list for MCS 4690/1 kit (up to 2009 with 4.8mm spade clutch switch connectors)

Parts list for MCS 4690/2 kit (from 2010 with JD 2-way clutch switch connectors)

<u>Item</u>	<u>Qty</u>	<u>Part Number</u>	<u>Description</u>
1	1	MCSU 400C	Computer
2	1	MCS 001	Foam mounting block
		<u>MCS 4692</u>	<u>Vacuum actuator assembly</u>
3	1	MCS 574	Vacuum actuator (triple solenoid)
4	1	MCS 4692A	Actuator mounting bracket
	3		6g x 3/8" self tap screw
5	2	HoseClamp8	Hose clamp 8~22mm
		<u>MCS 4697</u>	<u>Vacuum hose assembly</u>
6	2	MCS 032	Vacuum stop valve
7	1	MCS 031	4mm Vacuum Tee connector 4mm Vacuum hose
8	1	MCS 4691	Wiring loom (up to 2009)
OR	1	MCS 4699	Wiring loom (from 2010)
a			Computer plug (26 pin)
b			Fuse holder (3 amp fuse)
c			Tach sensor (yellow wire)
d			Speed sensor (co-axial wire)
e			Actuator plug (4 pin)
f			Power & brake sensor (orange and grey wires)
g			Ground connector (black wire)
h1			Clutch sensor (blue wire) (MCS 4691 loom, up to 2009)
h2			Clutch sensor (blue wire) (MCS 4699 loom, from 2010)
i			Control switch plug (6 pin)
		<u>MCS 4494</u>	<u>Control Switch assembly</u>
9	1	MCS 820	Control Switch
10	1	MCS 830W	Switch bracket
	4		4 gauge x 1/2" pan head self tap screw
		<u>MCS 4695</u>	<u>Cable Interface Unit (CIU) assembly</u>
12	1	MCS 4695A	CIU housing
13	1	MCS 003F	Actuator spool
14	1	MCS 4696	Dual spool
15	1	MCS 003H	Bush
16	1	MCS 003K	End Cap
17	1		M5 x 45 pivot bolt
18	1		Pivot nut M5 Nyloc nut
19	2		5mm plated flat washer
20	1		M4 x 10 pan head screw (actuator cable retainer)
21	1	MCS 4695B	CIU mounting bracket
22	2	HoseClamp6	Hose clamp 8~22mm
		<u>MCS 4698</u>	<u>Carburettor cable assembly</u>
23	1	MCSCC 250	Carburettor cable
24	1	MCS 003Z	6mm to 8mm adaptor washer
25	1		6mm flat washer

26	1	MCSU 430	Throttle cable removal and installation tool
	10		100mm cable ties
	6		150mm cable ties
	6		200mm cable ties
	2 ml		Throttle cable oil (Singer industrial sewing machine oil)

Information, Set up and Operation Manual
 Operation and User Manual
 Installation Manual
 Trouble shooting guide

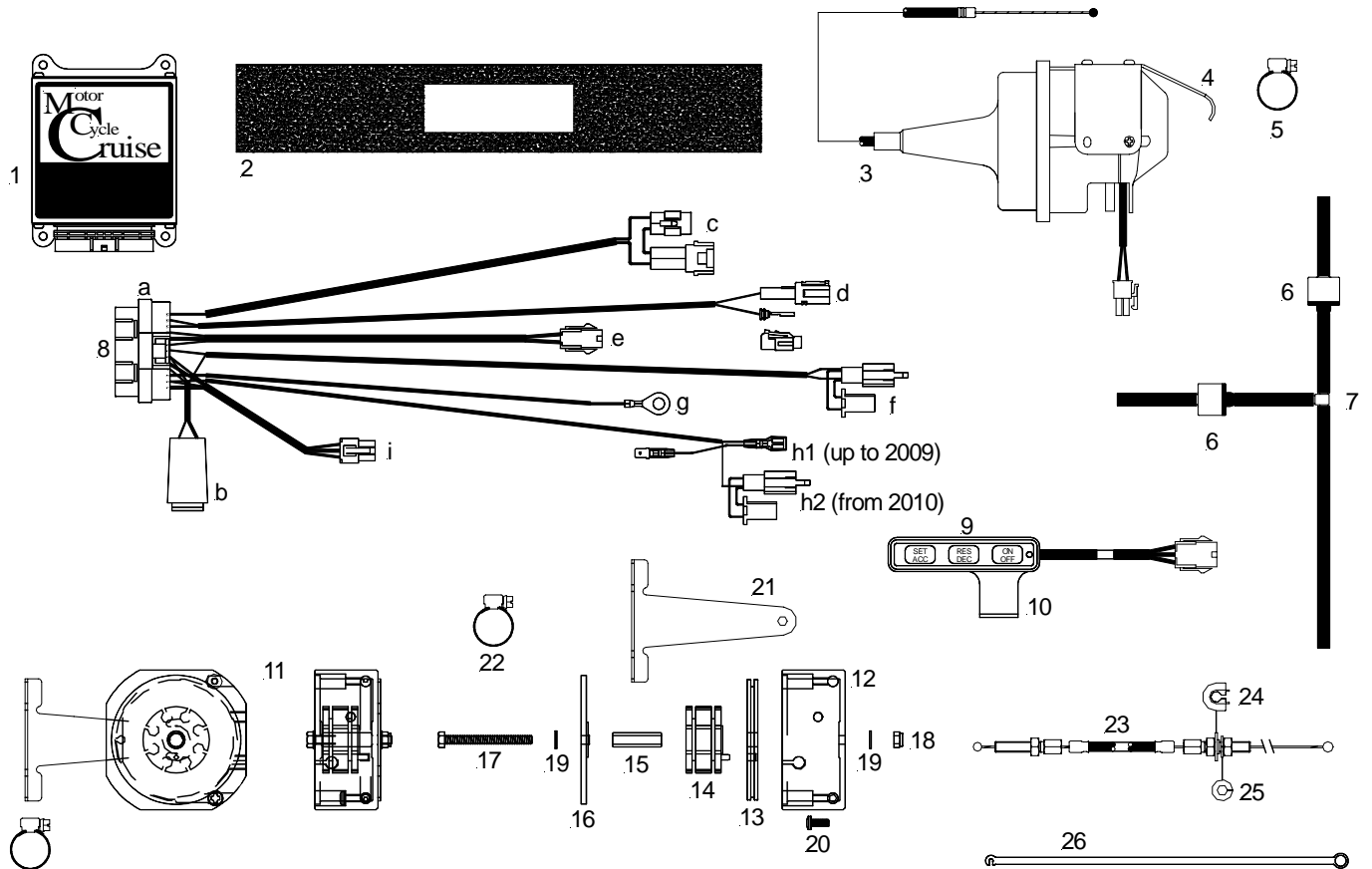

Dual spool hole marking

